

**Plastic fittings
for SFP polyamide flexible conduits**



6660 45

Straight SFP connectors

One-piece fixed male fitting, self extinguishing, halogen free polyamide material. Guarantees high resistance to pulling, provides IP 66 protection (and IP 68 with use of gasket) to the SFP system in both static and dynamic conditions.

ISO thread

pack (pcs)	cat. nos.	thread side	outside conduit diameter
100	6660 40	M12	10
50	6660 41	M16	12
50	6660 42	M16	16
50	6660 43	M20	16
50	6660 44	M20	20
50	6660 45	M25	20
50	6660 46	M25	25
25	6660 47	M32	32
25	6660 48	M40	40
10	6660 49	M50	50

PG thread

pack (pcs)	cat. nos.	thread side	outside conduit diameter
100	6660 25	PG7	10
100	6660 26	PG9	10
100	3814 30	PG13.5	10
50	6660 27	PG7	12
50	6660 28	PG9	12
50	6660 29	PG11	12
50	3814 40	PG13.5	12
50	6660 30	PG11	16
50	6660 31	PG13.5	16
50	3814 50	PG16	16
50	6660 32	PG13.5	20
50	6660 33	PG16	20
50	6660 34	PG16	25
50	6660 35	PG21	25
25	6660 36	PG29	32
25	6660 37	PG36	40
10	6660 38	PG42	50
10	6660 39	PG48	50

**Plastic fittings
for SFP polyamide flexible conduits**

Characteristics:

material: PA6.6 self extinguishing halogen free
 temperature rating: -45°C +105°C
 index of protection: IP66 with SFP connectors
 IP68 with SFP connectors and gasket
 heat resistance : glow wire test 850°C
 conduits: SFP standard page 50
 SFP heavy page 51
 SFP robotic page 52
 SFP overbraided page 53

Dimensions

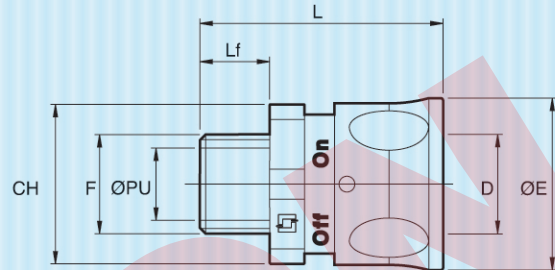

Cat. nos.	Dimensions (mm)						
	D	F	CH	ØPU	L	L1	ØE
6660 25	10	PG7	22	7	41.5	10	24
6660 26	10	PG9	22	7	41.5	10	24
3814 30	10	PG13.5	24	7	41.5	10	24
6660 27	12	PG7	24	8	41.5	10	26
6660 28	12	PG9	24	9	41.5	10	26
6660 29	12	PG11	24	9	41.5	10	26
3814 40	12	PG13.5	24	9	41.5	10	24
6660 30	16	PG11	28	12.5	46	12	30.5
6660 31	16	PG13.5	28	12.5	46	12	30.5
3814 50	16	PG16	28	12.5	46	12	30.5
6660 32	20	PG13.5	32	15.5	49	14	34.5
6660 33	20	PG16	32	15.5	49	14	34.5
6660 34	25	PG16	38	17.5	52	14	39.5
6660 35	25	PG21	38	19	52	14	39.5
6660 36	32	PG29	45	26	56	14	47
6660 37	40	PG36	54	33.4	59	14	55
6660 38	50	PG42	64	42.8	66	16	65
6660 39	50	PG48	64	42.8	66	16	65
6660 40	10	M12X1.5	22	7	41.5	10	24
6660 41	12	M16X1.5	24	9	41.5	10	26
6660 42	16	M16X1.5	28	11	46	12	30.5
6660 43	16	M20X1.5	28	12.5	46	12	30.5
6660 44	20	M20X1.5	32	14.5	49	14	34.5
6660 45	20	M25X1.5	32	15.5	49	14	34.5
6660 46	25	M25X1.5	38	19	52	14	39.5
6660 47	32	M32X1.5	45	26	56	14	47
6660 48	40	M40X1.5	54	33.4	59	14	55
6660 49	50	M50X1.5	64	42.8	66	16	65

**Plastic fittings
for SFP polyamide flexible conduits**



6660 65

SFP 90° connectors

Fixed 90° male fitting. Self-extinguishing, halogen free polyamide material. Guarantees high resistance to pulling, provides IP 66 protection (and IP 68 with use of gasket) to the SFP system in both static and dynamic conditions.

ISO thread

pack (pcs)	cat. nos.	thread size	outside conduit diameter
100	6660 60	M12	10
50	6660 61	M16	12
50	6660 62	M16	16
50	6660 63	M20	16
50	6660 64	M20	20
50	6660 65	M25	20
25	6660 66	M25	25
25	6660 67	M32	32

PG thread

pack (pcs)	cat. nos.	thread size	outside conduit diameter
100	6660 50	PG7	10
50	6660 51	PG7	12
50	6660 52	PG9	12
50	6660 53	PG11	16
50	6660 54	PG13.5	16
50	6660 55	PG13.5	20
50	6660 56	PG16	20
25	6660 57	PG16	25
25	6660 58	PG21	25
25	6660 59	PG29	32

**Plastic fittings
for SFP polyamide flexible conduits**

Characteristics:

material: PA6.6 self extinguishing halogen free
 temperature rating: -45°C +105°C
 index of protection: IP66 with SFP connectors
 IP68 with SFP connectors and gasket
 heat resistance : glow wire test 850°C
 conduits: SFP standard page 50
 SFP heavy page 51
 SFP robotic page 52
 SFP overbraided page 53

Dimensions

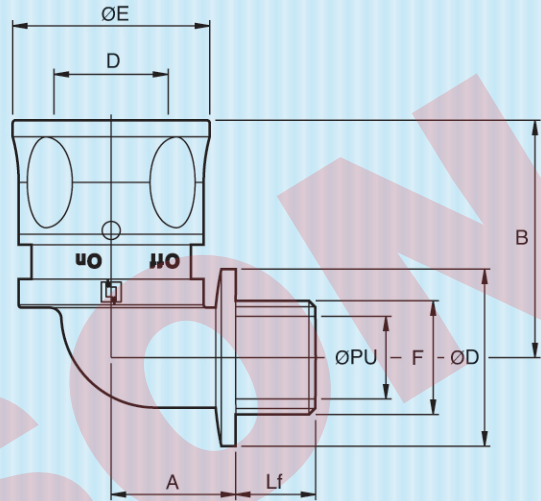

Cat. nos.	Dimensions (mm)							
	D	F	ØPU	A	B	Lf	ØE	ØD
6660 50	10	PG7	7	16	33.5	10	24	17.5
6660 51	12	PG7	8.2	17	34	10	26	21
6660 52	12	PG9	8.2	17	34	10	26	21
6660 53	16	PG9	10.4	19.5	39.5	12	30.5	26
6660 54	16	PG13.5	10.4	19.5	39.5	12	30.5	26
6660 55	20	PG13.5	13.8	22	41.5	14	34.5	31
6660 56	20	PG16	13.8	22	41.5	14	34.5	31
6660 57	25	PG16	16.9	25	48	14	39.5	34
6660 58	25	PG21	16.9	25	48	14	39.5	34
6660 59	32	PG29	25.3	28.5	58.5	14	47	43
6660 60	10	M12X1.5	7	16	33.5	10	24	17.5
6660 61	12	M16X1.5	8.2	17	34	10	26	21
6660 62	16	M16X1.5	10.4	19.5	39.5	12	30.5	26
6660 63	16	M20X1.5	10.4	19.5	39.5	12	30.5	26
6660 64	20	M20X1.5	13.8	22	41.5	14	34.5	31
6660 65	20	M25X1.5	13.8	22	41.5	14	34.5	31
6660 66	25	M25X1.5	16.9	25	48	14	39.5	34
6660 67	32	M32X4.5	25.3	28.5	58.5	14	47	43

**Plastic fittings
for SFP polyamide flexible conduits**



3814 21

SFP flanged connectors

One-piece flanged 90° polyamide fitting. Quick assembly and click locking, high resistance to tension, supplied with gasket.

pack (pcs)	cat. nos.	conduit diameter
10	3814 20	40
10	3814 21	50



3814 14

SFP TR protection ring

Metal ring for holding the metal braid wires when connecting straight SFP, 90° and flanged connectors to SFP TR conduit,.

pack (pcs)	cat. nos.	conduit diameter
25	3814 10	12
25	3814 11	16
25	3814 12	20
25	3814 13	25
10	3814 14	32
10	3814 15	40
5	3814 16	50

**Plastic fittings
for SFP polyamide flexible conduits**

Characteristics:

material: PA6.6 self extinguishing halogen free
 temperature rating: -45°C +105°C
 index of protection: IP66 with SFP conduits
 IP68 with SFP conduits and gasket
 conduits: SFP standard page 50
 SFP heavy page 51
 SFP robotic page 52
 SFP overbraided page 53

Dimensions:

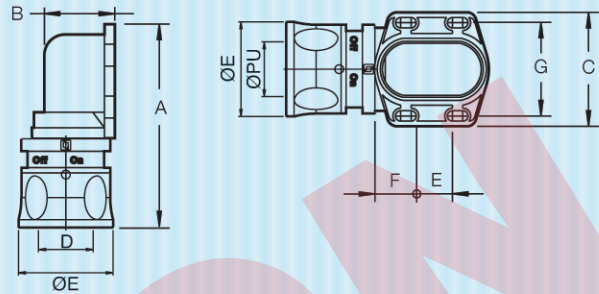

Cat. nos.	DIMENSIONS (mm)							
	Ø PU	A	B	C	Ø D	E	F	G
381420	33.4	120	57	87	55	35.5	29.8	75
381421	42.8	145	57	87	65	35.5	29.8	75

**Plastic fittings
for SFP polyamide flexible conduits**



6661 31

Polyamide connector - cable gland

Fast connection to the conduit. It performs the function of both a connector and a cable gland. The thermosetting elastomer rubber gasket assures both the locking together of both the cables and the conduit and guarantee its resistance to powder and liquids.

ISO thread

pack (pcs)	cat. nos.	thread size	outside conduit diameter	Ø cables	
				min.	max.
10	6661 30	M12	16	4	8
10	6661 31	M16	20	6	12
10	6661 32	M16	25	13	18
10	6661 33	M20	32	18	25

PG thread

pack (pcs)	cat. nos.	thread size	outside conduit diameter	Ø cables	
				min.	max.
10	6661 23	PG7	10	3	6,5
10	6661 24	PG9	10	4	8
10	6661 25	PG11,5	12	5	10
10	6661 26	PG13,5	16	6	12
10	6661 27	PG16,5	20	10	14
10	6661 28	PG21,5	25	13	18
10	6661 29	PG29,5	32	18	25

**Plastic fittings
for SFP polyamide flexible conduits**

Characteristics:

material: PA6.6 self extinguishing halogen free - black
 temperature rating: -45°C +105°C
 index of protection: IP66 with SFP conduits
 IP68 with SFP conduits and gasket
 IP68 side cable gland
 conduits: SFP standard page 50
 SFP heavy page 51
 SFP robotic page 52
 SFP overbraided page 53

Dimensions:

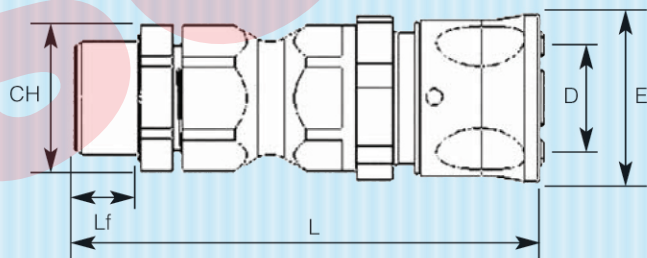
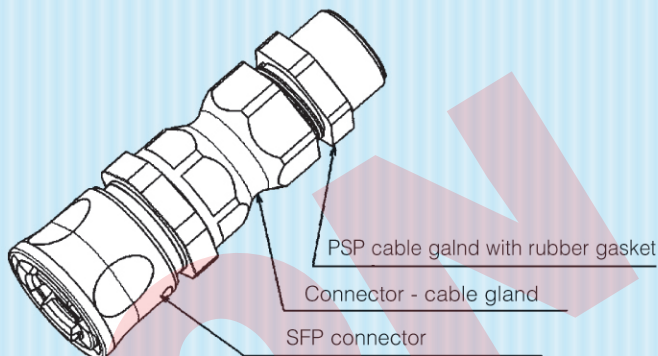

Connectors - cable glands

Dimensions:

	D	E	CH	L	Lf
6661 23	10	24	22	72	10
6661 24	10	24	22	72	10
6661 30	16	30,5	28	72	10
6661 31	20	34,5	32	80	12
6661 32	25	39,5	38	89	15
6661 33	32	47	45	104	15
6661 25	12	26	24	74	12
6661 26	16	30,5	28	80	12
6661 27	20	34,5	32	80	13
6661 28	25	39,5	38	91	15
6661 29	32	47	45	104	15

**Plastic fittings
for SFP polyamide flexible conduits**



SFP connector for sensors

Polyamide connector. Fast connection to the conduit. Connection to the sensors in transparent head.

Straight SPF connector

pack (pcs)	cat. nos.	outside conduit diameter	thread size
10	6661 06	10	M8 x 1
10	6661 07	10	M12 x 1
10	6661 08	10	M18 x 1
10	6661 09	10	M30 x 1,5
10	6661 10	12	M12 x 1
10	6661 11	12	M18 x 1
10	6661 12	12	M30 x 1,5

90° SPF connector

pack (pcs)	cat. nos.	outside conduit diameter	thread size
10	6661 16	10	M8 x 1
10	6661 17	10	M12 x 1
10	6661 18	10	M18 x 1
10	6661 19	10	M30 x 1,5
10	6661 20	12	M12 x 1
10	6661 21	12	M18 x 1
10	6661 22	12	M30 x 1,5

SFP "Y" fitting

Y piece comprising two identical parts for click together assembly. Fast connections

pack (pcs)	cat. nos.	conduit diameter
10	6661 00	12/10 x 2
10	6661 01	16/12 x 2
10	6661 02	20/12 x 2
10	6661 03	20/16 x 2
10	6661 04	25/20 x 2

**Plastic fittings
for SFP polyamide flexible conduits**

Characteristics:

material: PA6.6 self extinguishing halogen free. Black
 temperature rating: -45°C +105°C
 index of protection: IP66 with SFP conduits
 IP68 with SFP conduits and gasket
 conduits: SFP standard page 50
 SFP heavy page 51
 SFP robotic page 52
 SFP overbraided page 53

Dimensions:

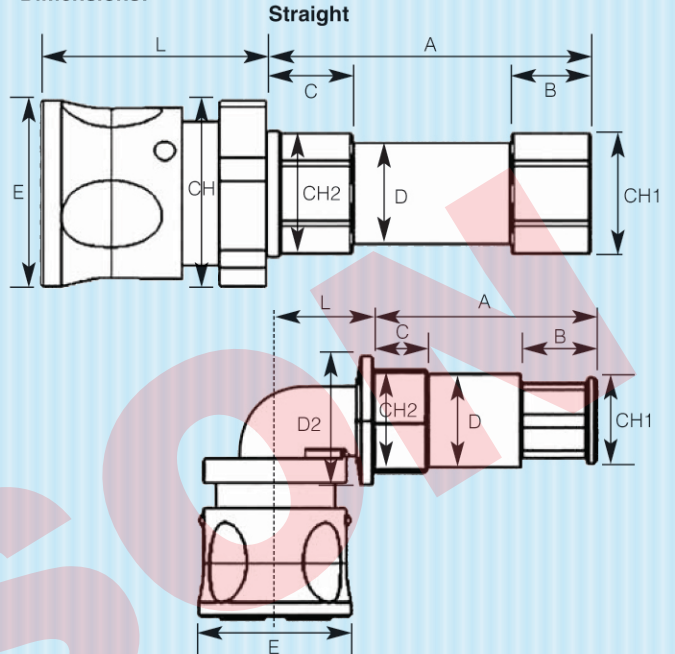

Dimensions:

Cat. nos.	A	B	C	Pu	CH1	CH2	D	L	E	CH3	D2
Straight											
666106	45	11	12	7	11	15	10	31,5	24	22	-
666107	45	11	12	10,65	17	17	14	31,5	24	22	-
666108	45	11	15	14	24	17	19	31,5	24	22	-
666109	45	11	10	26	39	17	30	31,5	24	22	-
666110	45	11	16	11	17	21	14	31,5	26	24	-
666111	45	11	10	15,5	24	21	19	31,5	26	24	-
666112	45	11	10	26	39	21	30	31,5	26	24	-
90°											
666116	45	11	12	7	11	15	10	33,5	24	-	17,5
666117	45	11	12	10,65	17	17	14	33,5	24	-	17,5
666118	45	11	15	14	24	17	19	33,5	24	-	17,5
666119	45	11	10	26	39	17	30	33,5	24	-	17,5
666120	45	11	16	11	17	21	14	34	26	-	21
666121	45	11	10	15,5	24	21	19	34	26	-	21
666122	45	11	10	26	39	21	30	34	26	-	21

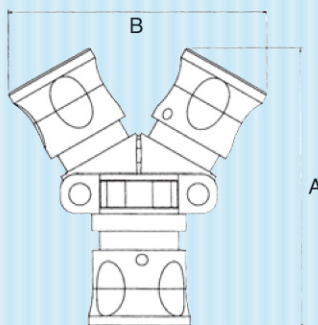

Cat. nos.	A	B
6661 00	70	65
6661 01	77	70
6661 02	82	72
6661 03	86	81
6661 04	92	86

**Plastic fittings
for SFP polyamide flexible conduits**



SFP fixing clip

Polyamide accessory for SFP conduit, with fastening screw. Prevents conduit from slipping under tension. Supplied with coupling pins to allow modular installation.

pack (pcs)	cat. nos.	conduit diameter
100	6660 68	10
100	6660 69	12
100	6660 70	16
50	6660 71	20
50	6660 72	25
25	6660 73	32
25	6660 74	40
25	6660 75	50



DIN rail clip

Accessory for locking SFP clips onto metal supports to DIN EN 50022-35x7.5/15mm.

pack (pcs)	cat. nos.	conduit diameter
50	6660 76	10 - 12
50	6660 77	16 - 20
25	6660 78	25 - 32
25	6660 79	40 - 50

SFP IP 68 gasket

Fixing gasket for SFP conduits. Provides IP 68 rating when located between the conduit and the connector.

pack (pcs)	cat. nos.	conduit diameter
100	6660 80	10
50	6660 81	12
50	6660 82	16
50	6660 83	20
50	6660 84	25
25	6660 85	32
25	6660 86	40
10	6660 87	50

**Plastic fittings
for SFP polyamide flexible conduits**

SFP fixing clip

Characteristics:

material: PA6.6 self extinguishing halogen free
 temperature rating: -45°C +105°C
 conduits: SFP standard, heavy, robotic

Dimensions

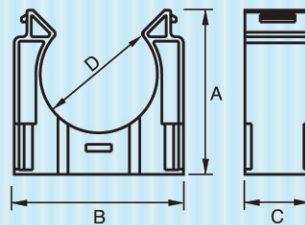

Cat. nos.	Dimensions (mm)			
	D	A	B	C
6660 68	10	21.5	22.5	18
6660 69	12	24.5	23.5	18
6660 70	16	28.5	26	18
6660 71	20	32.5	32	18
6660 72	25	39	38	18
6660 73	32	45	46.5	18
6660 74	40	53.5	53.5	18
6660 75	50	61	63	18

DIN rail clip

Suitable for SFP standard, heavy and robotic conduits.

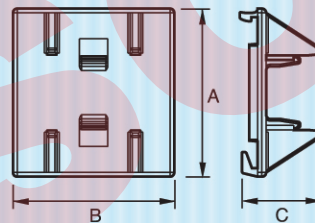

Cat. nos.	Dimensions (mm)			
	D	A	B	C
6660 76	10-12	40	21	17
6660 77	16-20	40	25	17.5
6660 78	25-32	40	38	20
6660 79	40-50	40	52	22.5

SFP gasket IP68

Suitable for SFP standard, heavy, robotic and overbraided conduits.

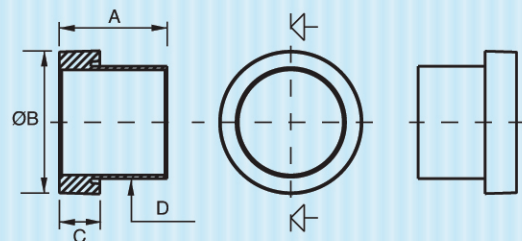

Cat. nos.	Dimensions (mm)			
	D	A	ØB	C
6660 80	10	10	9.7	3.6
6660 81	12	10	11.7	3.5
6660 82	16	11	15.6	3.5
6660 83	20	15	19.8	5
6660 84	25	19	24.9	7
6660 85	32	23	31.9	9
6660 86	40	24.5	39.9	9
6660 87	50	27.5	49.9	10

**Plastic fittings
for GP2 polyamide flexible conduits**



Gamma

One-piece fixed male polyamide fitting, quick assembly and click locking.

ISO thread

pack (pcs)	cat. nos. black	thread size	inside conduit diameter	rta cat. nos.
50	3812 75	M16x1.5	10.0	81275
50	3812 76	M16x1.5	12.0	81276
50	3812 78	M20x1.5	17.0	81278
25	3812 79	M25x1.5	22.5	81279
25	3812 80	M32x1.5	28.0	81280

pack (pcs)	cat. nos. grey	thread size	inside conduit diameter	rta cat. nos.
50	3818 75	M16x1.5	10.0	81275G
50	3818 76	M16x1.5	12.0	81276G
50	3818 78	M20x1.5	17.0	81278G
25	3818 79	M25x1.5	22.5	81279G
25	3818 80	M32x1.5	28.0	81280G

**Plastic fittings
for GP2 polyamide flexible conduits**

Gamma

Characteristics:

material: Polyamide PA6.6 UL 94-V0.
 temperature rating: -25°C +90°C
 index of protection: IP67 with GP2 conduits and O-ring
 IP55 with GP2 TR conduits
 conduit system: GP2 page 54
 GP2 TR page 55

Dimensions:

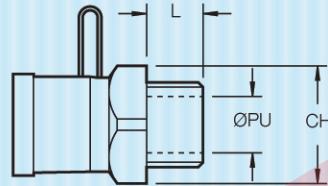

ISO thread		DIMENSIONS (mm)		
Cat. nos.		Ø PU	CH	L
black	grey			
3812 75	3818 75	10	20	12
3812 76	3818 76	10.5	25	12
3812 78	3818 78	14.5	27	13
3812 79	3818 79	19	36	14
3812 80	3818 80	25.5	43	14

**Plastic fittings
for GP2 polyamide flexible conduits**



Gamma

One-piece fixed male polyamide fitting, quick assembly and click locking.

PG thread

pack (pcs)	cat. nos. black	thread size	inside conduit diameter	rta cat. nos.
100	3812 61	PG7	7.0	81261
50	3812 63	PG9	10.0	81263
50	3812 65	PG11	12.0	81265
50	3812 66	PG13.5	12.0	81266
50	3812 67	PG13.5	17.0	81267
50	3812 68	PG16	17.0	81268
25	3812 69	PG21	22.5	81269
25	3812 70	PG29	28.0	81270
10	3812 71	PG36	35.0	81271
5	3812 73	PG48	47.0	81273

PG thread

pack (pcs)	cat. nos. grey	thread size	inside conduit diameter	rta cat. nos.
100	3818 61	PG7	7.0	81261G
50	3818 63	PG9	10.0	81263G
50	3818 65	PG11	12.0	81265G
50	3818 66	PG13.5	12.0	81266G
50	3818 67	PG13.5	17.0	81267G
50	3818 68	PG16	17.0	81268G
25	3818 69	PG21	22.5	81269G
25	3818 70	PG29	28.0	81270G
10	3818 71	PG36	35.0	81271G
5	3818 73	PG48	47.0	81273G

**Plastic fittings
for GP2 polyamide flexible conduits**

Gamma

Characteristics:

material: Polyamide PA6.6 UL 94-V0.
 temperature rating: -25°C +90°C
 index of protection: IP67 with GP2 conduits and O-ring
 IP55 with GP2 conduits
 IP55 with GP2 TR conduits
 conduit system: GP2 page 54
 GP2 TR page 55

Dimensions

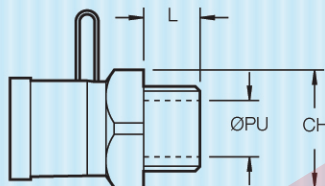

PG thread		DIMENSIONS (mm)		
Cat. nos.		Ø PU	CH	L
black	grey			
3812 61	3818 61	7	17	10
3812 63	3818 63	10	20	12
3812 65	3818 65	10.5	25	12
3812 66	3818 66	11	25	13
3812 67	3818 67	14.5	27	13
3812 68	3818 68	14.5	27	13
3812 69	3818 69	19	36	14
3812 70	3818 70	25.5	43	15
3812 71	3818 71	32.5	50	15
3812 73	3818 73	44	65	20

**Plastic fittings
for GP2 polyamide flexible conduits**



Gamma

One-piece fixed male polyamide fitting, quick assembly and click locking.

Gas thread

pack (pcs)	cat. nos. black	thread size	inside conduit diameter	rta cat. nos.
100	3812 50	G1/4"	7.0	81250
50	3812 51	G1/4"	10.0	81251
50	3812 52	G3/8"	10.0	81252
50	3812 53	G3/8"	12.0	81253
50	3812 54	G1/2"	12.0	81254
50	3812 55	G1/2"	17.0	81255
25	3812 56	G3/4"	22.5	81256
25	3812 57	G1"	28.0	81257
10	3812 58	G1 1/4"	35.0	81258
10	3812 59	G1 1/2"	47.0	81259
5	3812 60	G2"	47.0	81260

Gas thread

pack (pcs)	cat. nos. grey	thread size	inside conduit diameter	rta cat. nos.
100	3818 50	G1/4"	7.0	81250G
50	3818 51	G1/4"	10.0	81251G
50	3818 52	G3/8"	10.0	81252G
50	3818 53	G3/8"	12.0	81253G
50	3818 54	G1/2"	12.0	81254G
50	3818 55	G1/2"	17.0	81255G
25	3818 56	G3/4"	22.5	81256G
25	3818 57	G1"	28.0	81257G
10	3818 58	G1 1/4"	35.0	81258G
10	3818 59	G1 1/2"	47.0	81259G
5	3818 60	G2"	47.0	81260G

**Plastic fittings
for GP2 polyamide flexible conduits**

Gamma

Characteristics:

material: Polyamide PA6.6 UL 94-V0.
 temperature rating: -25°C +90°C
 index of protection: IP67 with GP2 conduits and O-ring
 IP55 with GP2 conduits
 IP55 with GP2 TR conduits
 conduit system: GP2 page 54
 GP2 TR page 55

Dimensions

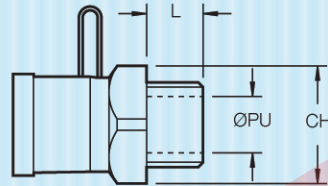

Gas thread		DIMENSIONS (mm)		
Cat. nos.		Ø PU	CH	L
black	grey			
3812 50	3818 50	7	17	10
3812 51	3818 51	8	20	10
3812 52	3818 52	10	20	12
3812 53	3818 53	10.5	25	12
3812 54	3818 54	11	25	13
3812 55	3818 55	14.5	27	13
3812 56	3818 56	19	36	14
3812 57	3818 57	25.5	43	15
3812 58	3818 58	32.5	50	15
3812 59	3818 59	39.5	65	18
3812 60	3818 60	44	65	20

**Plastic fittings
for GP2 polyamide flexible conduits**



3819 17



3819 55

Gamma 90°

One-piece fixed male polyamide fitting, quick assembly and click locking.

ISO thread

pack (pcs)	cat. nos. black	thread size	inside conduit diameter	rta cat. nos.
50	3819 26	M16x1.5	12.0	8127690
50	3819 28	M20x1.5	17.0	8127890
25	3819 29	M25x1.5	22.5	8127990
20	3819 30	M32x1.5	28.0	8128090

pack (pcs)	cat. nos. grey	thread size	inside conduit diameter	rta cat. nos.
50	3819 76	M16x1.5	12.0	8127690G
50	3819 78	M20x1.5	17.0	8127890G
25	3819 79	M25x1.5	22.5	8127990G
20	3819 80	M32x1.5	28.0	8128090G

PG thread

pack (pcs)	cat. nos. black	thread size	inside conduit diameter	rta cat. nos.
50	3819 15	PG11	12.0	8126590
50	3819 17	PG13.5	17.0	8126790
50	3819 18	PG16	17.0	8126890
25	3819 19	PG21	22.5	8126990
20	3819 20	PG29	28.0	8127090

pack (pcs)	cat. nos. grey	thread size	inside conduit diameter	rta cat. nos.
50	3819 65	PG11	12.0	8126590G
50	3819 67	PG13.5	17.0	8126790G
50	3819 68	PG16	17.0	8126890G
25	3819 69	PG21	22.5	8126990G
20	3819 70	PG29	28.0	8127090G

**Plastic fittings
for GP2 polyamide flexible conduits**

Gamma 90°

Characteristics:

material: Polyamide PA6.6 UL 94-V0.
 temperature rating: -25°C +90°C
 index of protection: IP67 with GP2 conduits and O-ring
 IP55 with GP2 conduits
 IP55 with GP2 TR conduits
 GP2 page 54
 GP2 TR page 55

conduit system:

Dimensions

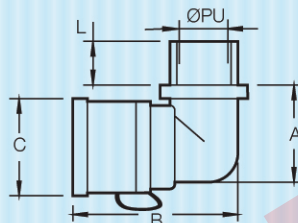

ISO thread		DIMENSIONS (mm)				
Cat. nos.		Ø PU	A	B	Ø C	L
black	grey					
3819 26	3819 76	11	26	40.5	23	12
3819 28	3819 78	14.5	33	53	29	13
3819 29	3819 79	19	42	67.5	38	14
3819 30	3819 80	25.5	48.5	75	44	15

PG thread		DIMENSIONS (mm)				
Cat. nos.		Ø PU	A	B	Ø C	L
black	grey					
3819 15	3819 65	11	26	40.5	23	12
3819 17	3819 67	14.5	33	53	29	13
3819 18	3819 68	14.5	33	53	29	13
3819 19	3819 69	19	42	67.5	38	14
3819 20	3819 70	25.5	48.5	75	44	15

**Plastic fittings
for GP2 polyamide flexible conduits**



3819 17



3819 55

Gamma 90°

One-piece fixed male polyamide fitting, quick assembly and click locking.

Gas thread

pack (pcs)	cat. nos. black	thread size	inside conduit diameter	rta cat. nos.
50	3819 03	G3/8"	12.0	8125390
50	3819 05	G1/2"	17.0	8125590
25	3819 06	G3/4"	22.5	8125690
20	3819 07	G1"	28.0	8125790

pack (pcs)	cat. nos. grey	thread size	inside conduit diameter	rta cat. nos.
50	3819 53	G3/8"	12.0	8125390G
50	3819 55	G1/2"	17.0	8125590G
25	3819 56	G3/4"	22.5	8125690G
20	3819 57	G1"	28.0	8125790G



3819 08



3819 58

Gamma 90° flanged

One-piece flanged 90° polyamide fitting. Quick assembly and click locking, supplied with gasket.

pack (pcs)	cat. nos. black	inside conduit diameter	rta cat. nos.
10	3819 08	35	81258FL
5	3819 10	47	81260FL

pack (pcs)	cat. nos. grey	inside conduit diameter	rta cat. nos.
10	3819 58	35	81258FLG
5	3819 60	47	81260FLG

**Plastic fittings
for GP2 polyamide flexible conduits**

Gamma 90°

Characteristics:
 material: Polyamide PA6.6 UL 94-V0.
 temperature rating: -25°C +90°C
 index of protection: IP67 with GP2 conduits and O-ring
 IP55 with GP2 conduits
 IP55 with GP2 TR conduits
 GP2 page 54
 GP2 TR page 55

Dimensions

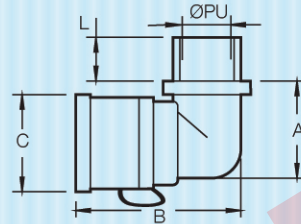

Gas thread		DIMENSIONS (mm)				
Cat. nos.		Ø PU	A	B	Ø C	L
black	grey					
3819 03	3819 53	11	26	40.5	23	12
3819 05	3819 55	14.5	33	53	29	13
3819 06	3819 56	19	42	67.5	38	14
3819 07	3819 57	25.5	48.5	75	44	15

Gamma 90° flanged

Characteristics:
 material: Polyamide PA6.6 UL 94-V0.
 temperature rating: -25°C +90°C
 index of protection: IP67 with GP2 conduits and O-ring
 IP55 with GP2 conduits
 IP55 with GP2 TR conduits
 GP2 page 54
 GP2 TR page 55

Dimensions

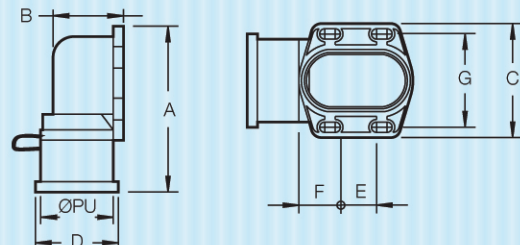

Gamma 90° flanged		DIMENSIONS (mm)							
Cat. nos.		Ø PU	A	B	C	Ø D	E	F	G
black	grey								
3819 08	3819 58	30	106	49	72	52.5	28.5	23.3	60
3819 10	3819 60	37	128	57	87	66	35.5	29.8	75

**Plastic fittings
for GP2 polyamide flexible conduits**

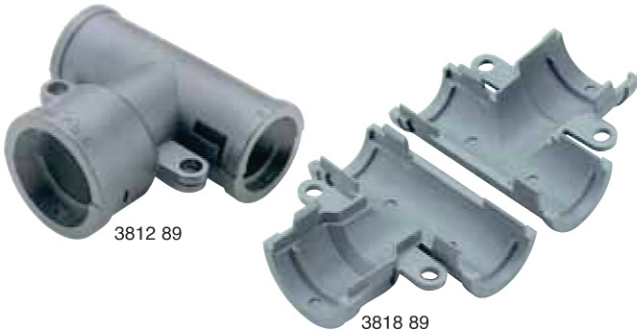

Gamma “T” fitting

T-piece comprising two identical parts for click together assembly. Two side lugs are provided for a security fastener if required.

pack (pcs)	cat. nos. black	inside conduit diameter	rta cat. nos.
20	3812 89	22.5-17	81289
20	3812 90	28-22.5	81290
pack (pcs)	cat. nos. grey	inside conduit diameter	rta cat. nos.
20	3818 89	22.5-17	81289G
20	3818 90	28-22.5	81290G

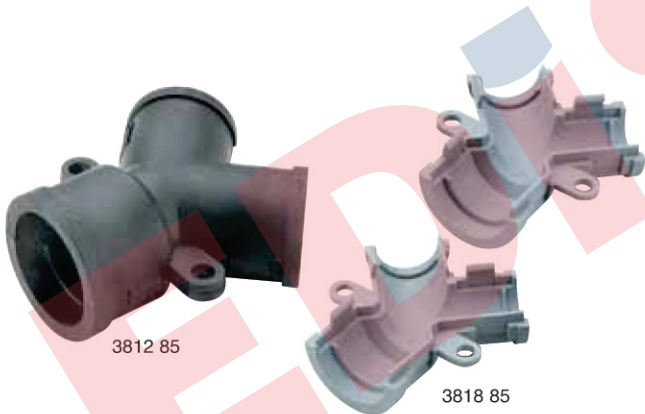

Gamma “Y” fitting

Y-piece comprising two identical parts for click together assembly. Two side lugs are provided for a security fastener if required.

pack (pcs)	cat. nos. black	inside conduit diameter	rta cat. nos.
50	3812 85	17-12	81285
25	3812 86	22.5-17	81286
pack (pcs)	cat. nos. grey	inside conduit diameter	rta cat. nos.
50	3818 85	17-12	81285G
25	3818 86	22.5-17	81286G

**Plastic fittings
for GP2 polyamide flexible conduits**

“T” fittings

Characteristics:
material: Polyamide PA6.6 UL 94-V0.
temperature rating: - 25°C +90°C
conduit system: GP2 page 54
GP2TR page 55

Dimensions

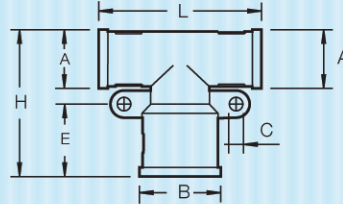

“T” fitting		DIMENSIONS (mm)					
Cat. nos.		∅ A	∅ B	∅ C	E	H	L
black	grey						
3812 89	3818 89	29	37	5	26	62	69
3812 90	3818 90	37	43	5	21	72	80

“Y” fittings

Characteristics:
material: Polyamide PA6.6 UL 94-V0.
temperature rating: -25°C +90°C
conduit system: GP2 page 54
GP2TR page 55

Dimensions

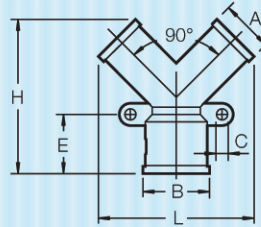

“Y” fitting		DIMENSIONS (mm)					
Cat. nos.		∅ A	∅ B	∅ C	E	H	L
black	grey						
3812 85	3818 85	24	29	5	25	62	60
3812 86	3818 86	29	37	5	26	67.5	69

**Plastic accessories
for GP2 polyamide flexible conduits**



3818 94

GP2 fixing clips

Polyamide accessory for GP2 conduits, with mounting screw. Prevents conduit from slipping under tension. Supplied with coupling pins to allow modular installation.

pack (pcs)	cat. nos. black	inside conduit diameter	rta cat. nos.
100	3812 91	7.0	81291
100	3812 92	10.0	81292
100	3812 93	12.0	81293
100	3812 94	17.0	81294
50	3812 95	22.5	81295
50	3812 96	28.0	81296
25	3812 97	35.0	81297
25	3812 98	47.0	81298

pack (pcs)	cat. nos. grey	inside conduit diameter	rta cat. nos.
100	3818 91	7.0	81291G
100	3818 92	10.0	81292G
100	3818 93	12.0	81293G
100	3818 94	17.0	81294G
50	3818 95	22.5	81295G
50	3818 96	28.0	81296G
25	3818 97	35.0	81297G
25	3818 98	47.0	81298G

**Plastic accessories
for GP2 polyamide flexible conduits**

Fixing clips

Characteristics:

material: Polyamide PA6.6 UL 94-V0.
temperature rating: -25°C +90°C
conduit system: GP2 page 54

Dimensions

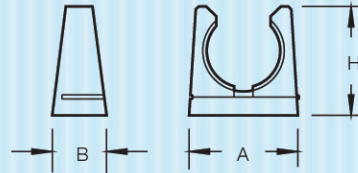

Fixing clip		DIMENSIONS (mm)			
Cat. nos.		A	B	H	vite
black	grey				
3812 91	3818 91	18	16	18	M4
3812 92	3818 92	19.5	16	22	M5
3812 93	3818 93	22.5	16	25	M5
3812 94	3818 94	29.5	16	32	M5
3812 95	3818 95	38	18	40	M6
3812 96	3818 96	45	18	48	M6
3812 97	3818 97	55	20	56.5	M6
3812 98	3818 98	69.5	20	69.5	M6

**Plastic accessories
for GP2 polyamide flexible conduits**



3865 44

O-ring gasket

Sealing ring for GP2 conduit. IP 68 rating if located between GP2 conduit and the Gamma connector.

pack (pcs)	cat. nos.	inside conduit diameter	rta cat. nos.
100	3865 41	7.0	86541
100	3865 42	10.0	86542
100	3865 43	12.0	86543
100	3865 44	17.0	86544
100	3865 45	22.5	86545
100	3865 46	28.0	86546
100	3865 47	35.0	86547
100	3865 48	47.0	86548

**Plastic accessories
for GP2 polyamide flexible conduits**



3813 16

GP2 TR protection ring

Metal ring for holding the metal braid wires when connecting straight Gamma, 90° and flanged connectors to GP2 TR conduit.

pack (pcs)	cat. nos.	inside conduit diameter	rta cat. nos.
10	3813 11	10.0	81310TR
10	3813 13	12.0	81312TR
10	3813 16	17.0	81317TR
10	3813 21	22.5	81322TR
10	3813 29	28.0	81328TR
5	3813 35	35.0	81335TR
5	3813 48	47.0	81347TR

EDISON