

Pressure gauge valve similar DIN 16 270 DVGW tested

Design A
with adjusting nut
DIN 16 283

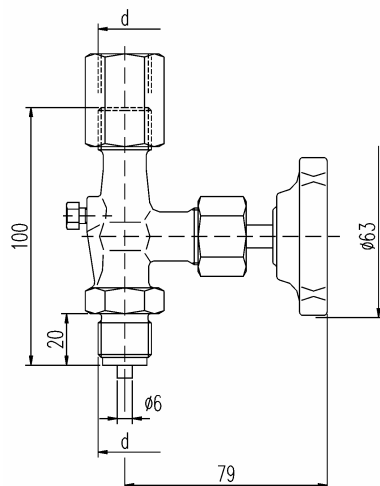

Design B

with swivel nut and shaft for
pressure gauge support

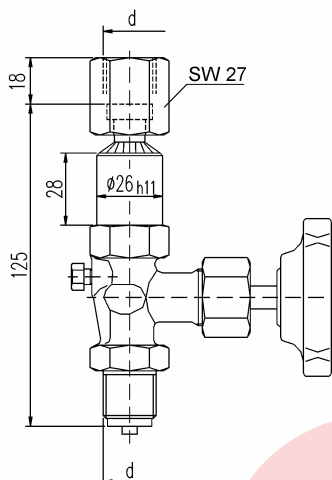

Design B-AS12

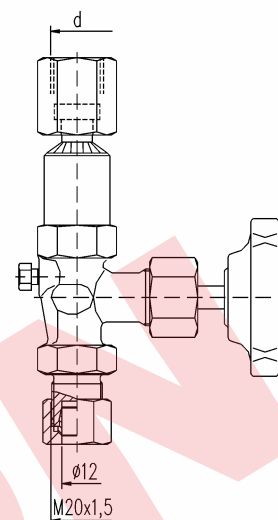

tube fitting O. D. 12 mm line S

D V G W - Registration

DVGW-Register-No.

DG-4315AO0764

PN	Connection thread d	Material	Part no.		
			Design A	Design B	Design B-AS12
100	G 1/2	brass steel st. stl.	15-V02-0A-MS-51-100-DVGW 15-V02-0A-SC-51-100-DVGW 15-V02-0A-SS-51-100-DVGW	15-V02-0B-MS-51-100-DVGW 15-V02-0B-SC-51-100-DVGW 15-V02-0B-SS-51-100-DVGW	- 15-V02-0BA-SC-51-100-DVGW 15-V02-0BA-SS-51-100-DVGW

Components	Brass	Steel	Stainless steel
	DIN-Material Number		
Body	brass	1.0460	316Ti (1.4571)
Valve stem	1.4104		316Ti (1.4571)
Needle tip	1.4104		316Ti (1.4571)
O-rings	FPM (Viton)		
O-ring retainer	brass		316Ti (1.4571)
Union nut	galv. steel		stainless steel
Adjusting nut	brass	steel	stainless steel
Swivel nut	brass	steel	316Ti (1.4571)
Vent screw	316Ti (1.4571)		
Hand wheel	plastic		

- **Body:** brass: pressed part
steel/stainless steel: die-pressed part
- **Surface:** steel phosphatized
- Internal stem thread
- Stem with colled rolled surface and non-rotating needle tip
- Max. operating pressure: 100 bar
- Temperature: -10 °C up to +70 °C
- DVGW tested in accordance with DIN 3537 part 1
- For all kinds of gas in accordance with DVGW-list number G 260
- Available with inspection certificate 3.1.B according to EN 10 204