

Type 40DDG, 50DDG Direct Drive Gauge



FEATURES

- *Direct drive technology provides excellent shock resistance, no gears to jam*
- *ASME B40.100 Grade B accuracy ($\pm 3-2-3\%$) in a commercial grade direct drive gauge*
- *No loose pointers*
- *Lightweight*
- *Smoother pointer rotation*
- *Cost effective*

Ashcroft® direct drive gauge technology provides excellent shock resistance. Testing has shown these gauges to be **four times** more shock resistant than conventional fixed movement gauges! Direct drive gauges have no gears to jam or wear out. The net result is a gauge that arrives at your facility to specified calibration parameters and stays that way throughout the service life of the gauge.

Ashcroft® direct drive gauges are lightweight, attractive, and durable, plus the sealed case construction makes this product appropriate for many harsh environmental conditions. This winning combination of features is only available in Ashcroft® direct drive gauges.

Ashcroft® direct drive gauges are available in a 40mm and 50mm ABS/polycarbonate blend case with integral socket. The molded case and socket design helps address cross threading problems which can occur when mating a brass socket into a plastic housing. Brass sockets are available as an optional feature.

COMMONLY USED ON

Filter regulator lubricators, portable compressors, medical/dental equipment, industrial machinery, paint spray equipment, air tanks, a variety of other applications

PRODUCT SPECIFICATIONS

ASHCROFT®

Model No.: 40DDG/50DDG

Dial Size: 40mm (1½") or 50mm (2") diameter

Case: ABS/polycarbonate blend, black

Lens: Polycarbonate, ultrasonically welded to case

Dial: Plastic, black figures on white background

Pointer: Brass, painted black

Bourdon Tube: Beryllium copper coil, silicone dampened

Bourdon Tube/Case Seal: Buna-N O-ring

Movement: None (direct drive)

Socket: Integral ABS polycarbonate blend

Connections: 40 DDG—½ NPT back
50 DDG—½ NPT or ¼ NPT back

Ranges: 0/60 (180° arc), 0/100, 0/160, 0/200, 0/300 and 0/400 psi (235° arc)
For optimum gauge life, select a gauge with a full scale pressure range of approximately twice the maximum excursion pressure.

Repeatability: Within 1%

Pressure Relief: Mylar tape dot

Accuracy: ASME B40.100 Grade B ($\pm 3/2/3\%$)

Overpressure: 110% of range

Operating pressure: -40°F to 150°F; -40°C to 65°C

OPTIONAL FEATURES

- Custom dials
 - Throttle plugs
 - Brass socket; ½ NPT or ¼ NPT back
 - Special connections, on application
 - Red or white pointers
 - Bulk pack in returnable PVC trays
 - Special accuracy, on application
- Consult factory for high cycle life applications.*

HOW TO ORDER (Typical example)

Dial Size: 40mm _____ **40**

Case Type: Direct Drive Gauge _____ **DDG**

Connection Size/Location: ½ NPT Back _____ **01B**

Connection Material: P=ABS, H=Brass _____ **P**

Options: Throttle Plug (.013" orifice) _____ **(X)T5**

Range: 0/100 psi _____ **100#**

Type 40DDG, 50DDG Direct Drive Gauge

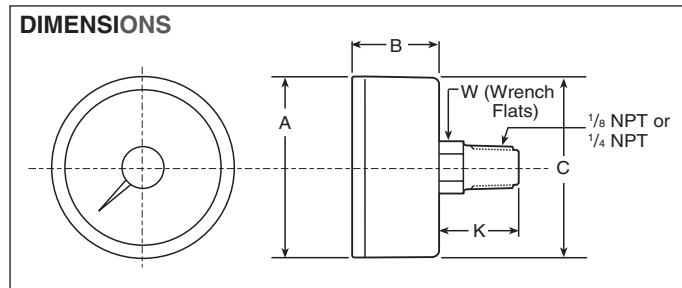

Dial Size	A	B	C	K		W	
				1/8 NPT	1/4 NPT	1/8 NPT	1/4 NPT
1 1/2" (40mm)	1.63 (42)	.71 (18)	1.63 (42)	.65 (17)	.90* (23)	.44 (11)	.56* (14)
2" (50mm)	2.15 (54)	.71 (18)	2.15 (54)	.65 (17)	.90 (23)	.44 (11)	.56 (14)

* Brass socket only