

Type MFX Fire Extinguisher Gauge



FEATURES

- *Sealed stainless steel case provides a weatherproof, dustproof corrosion-resistant gauge*
- *High impact-resistant polycarbonate window*
- *Meets applicable UL specifications*
- *Mass spectrometer leak tested*

Ashcroft® fire extinguisher gauges are mass spectrometer leak tested, thereby ensuring the critical leak integrity needed to prevent loss of extinguishing agent. These high-quality gauges are constructed with a corrosion-resistant stainless steel case and high impact-resistant polycarbonate window. Dial faces can be customized to meet customer requirements. The spiral tube technology used in these gauges offers the necessary accuracy without the complication of gearing, linkages and bearings that are present in a conventional movement gauge.

Ashcroft fire extinguisher gauges are made specifically for portable fire extinguishers, extinguishing systems, industrial and residential use.

PRODUCT SPECIFICATIONS

Ashcroft® Model No.: 12MFX, 15MFX

Accuracy: Conforms to applicable UL specs*

Size: 12MFX – 1¼"
15MFX – 1½"

Case: Stainless steel, sealed

Ring: None

Window: High impact-resistant polycarbonate

Dial: Conforms to applicable UL specs*

Pointer: Integral with Bourdon tube, brass painted yellow

Bourdon tube: Beryllium copper, spiral

Movement: None (direct reading)

Socket: Brass

Restrictor: None

Connection: ½ NPT back, standard

Ranges: Maximum pressure scale from 200 psi to 4000 psi

OPTIONAL FEATURES

Socket: ¼ NPT; throttle plugs, 0.007", 0.013", 0.020", 0.063" orifice

Others: Customized dials
Silicone-filled spiral tube for corrosion protection
Special socket configurations

*Applicable UL specs:
UL 299, UL 626, UL 1058, UL 1093

HOW TO ORDER (Typical example)

Dial Size: 1¼" 12 MFX 01B 400 C195 P

Case Type Number: MFX

Connection Size/Location: ½ NPT Back

Range: 400 psi

Charge Pressure:

Extinguishing Agent: Dry Chemical (P), Halon 1301 (F), Halon 1211 (H),
Water (W), Alternative (A)

Type MFX Fire Extinguisher Gauge

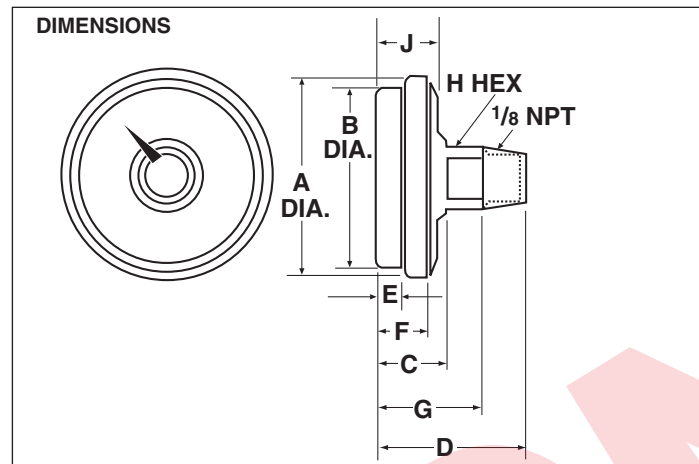

MODEL NO. inches (mm)	A	B	C	D		E	F	G	H		J
				1/4 NPT	1/8 NPT				1/4 NPT	1/8 NPT	
12MFX	1.45 (37)	1.25 (32)	0.5 (13)	1.25 (32)	1.06 (27)	0.20 (5)	0.40 (10)	0.71 (18)	9/16 (14)	7/16 (11)	0.43 (11)
15MFX	1.68 (43)	1.48 (37)	0.5 (13)	1.25 (32)	1.06 (27)	0.20 (5)	0.40 (10)	0.71 (18)	9/16 (14)	7/16 (11)	0.43 (11)