

Type 1009AW Stainless Case Gauge with Bronze System



FEATURES

- **Patented PowerFlex™ movement**
- **All welded construction**
- **1% full scale accuracy, ASME Grade 1A**
- **True Zero™ pointer indication**
- **NEW ventable plug**
- **NEW patent pending through-dial calibration**
- **NEW MSL helium leak tested to 1X10⁻⁶ ATM -cc/sec**
- **Meets ASME B40.100 and EN837-1 standards**
- **RoHS compliant**
- **CRN approved**
- **5 year limited warranty**

Ashcroft is pleased to reintroduce the 1009AW Duralife® pressure gauge. This gauge has been upgraded with many new features outlined above while maintaining the tried and true performance and quality you have come to expect.

Duralife 1009AW gauges provide significant features and benefits. New features include a ventable plug that can be sealed or vented depending on your environment and a patent pending through-dial recalibration that reduces recalibration time.

The combination of features including the patented PowerFlex™ movement and optional PLUS!™ Performance dampening system in the Ashcroft Duralife 1009AW gauge is the finest gauge technology for vibration, shock and pulsation applications. Available in pressure ranges from vacuum to 1000 psi, including compound and metric ranges.

PRODUCT SPECIFICATIONS

Ashcroft	
Type No.:	1009AW
Sizes:	2½", 3½"
Case:	304SS
Ring:	304SS polished bayonet
Window:	Polycarbonate
Dial:	Black figures on white background, aluminum
Pointer:	Friction adjust, black, aluminum
Bourdon Tube:	316L stainless steel C-Shaped (vacuum-600 psi and compound) Helical (1000psi)
Socket:	Bronze
Movement:	300 series stainless steel, PowerFlex, polyester segment, overload/underload stops
Connections:	¼ and ½ NPT, lower or lower back
Ranges:	Vac-1000psi and compound
Accuracy:	1% full scale; ASME Grade 1A
Fill Plug:	Ventable
Protection:	Nema 4X / IP65 plug sealed Nema 3 / IP54 plug vented
Ambient Temperature Limitations:	-40°F to 200°F dry +20°F to 150°F glycerin filled -40°F to 150°F silicone filled (based on standard polycarbonate window)
OPTIONAL FEATURES	
Liquid fill:	Glycerin, silicone, halocarbon (includes throttle plug)
Dampening:	PLUS!™ Performance (LL) (includes throttle plug)
Window:	Safety glass (SG)
Pointer:	Micrometer (MP)
Connections:	Metric and SAE
Mounting:	U-clamp (UC), Front flange (FF), Back flange (FW)
Dials:	Receiver ranges, refrigerant ranges; custom dials

HOW TO ORDER (Typical example)

Dial Size: 2½" (25), 3½" (35) 35
 Case Type: 1009 1009
 Tube and Socket Material: 316L SS & Bronze AW (L)
 Liquid Filled: (glycerin) leave blank if dry 02L
 Connection Size: ¼ (01), ½ (02) XXX
 Connection Location: Lower (L), Lower Back (B) 100#
 Options: _____
 Range: 0/100 psi _____

Type 1009AW Stainless Case Gauge with Bronze System



DIMENSIONS

**2½" 1009 Lower
and Back Connect**

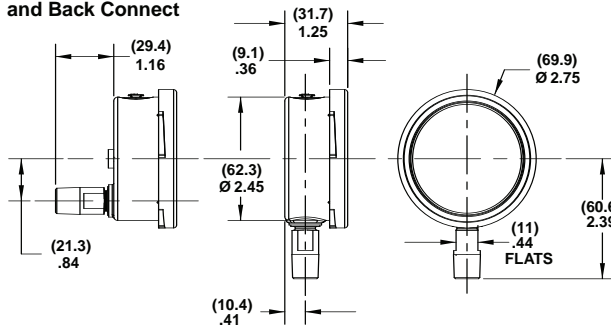

**3½" 1009 Lower
and Back Connect**

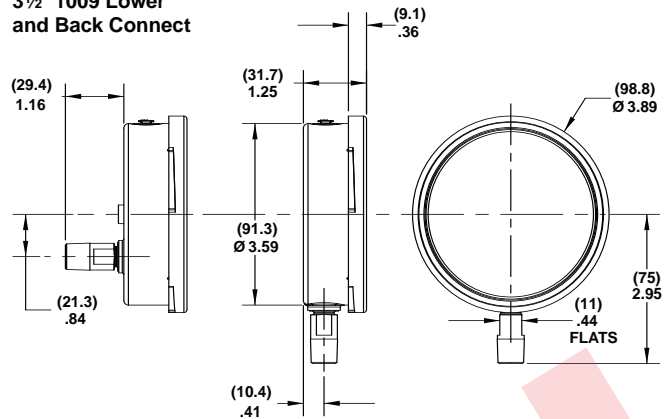

2½" 1009 Back Connect (XUC)

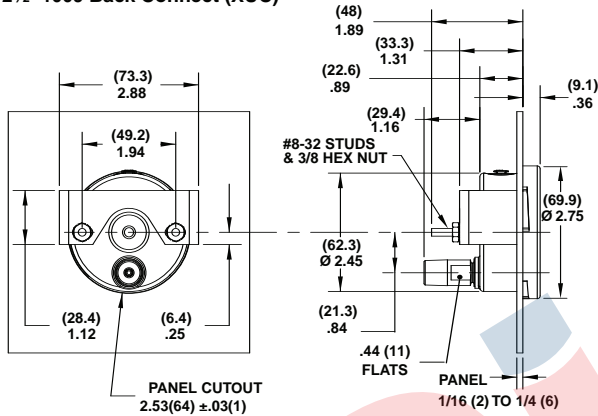

3½" 1009 Back Connect (XUC)

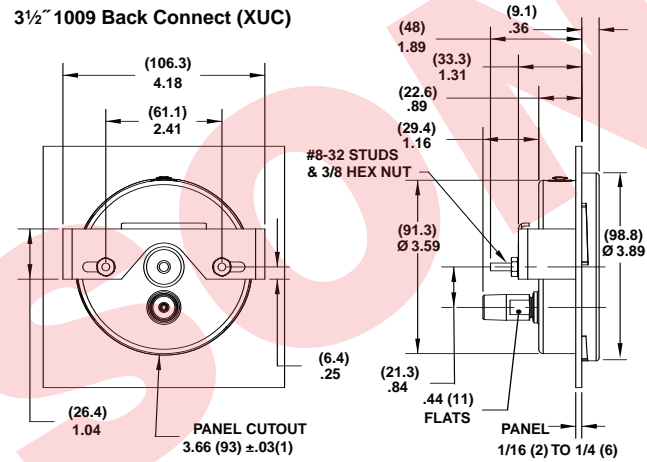

**2½" 1009 Back
Connect (XFF)**

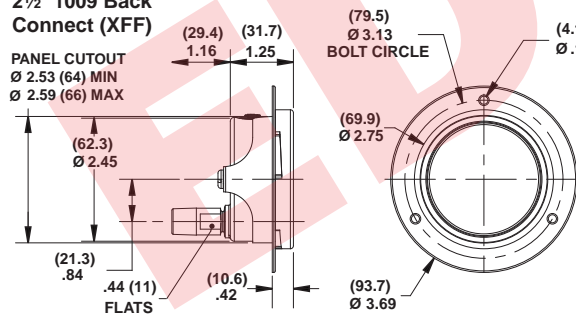

**3½" 1009 Back
Connect (XFF)**

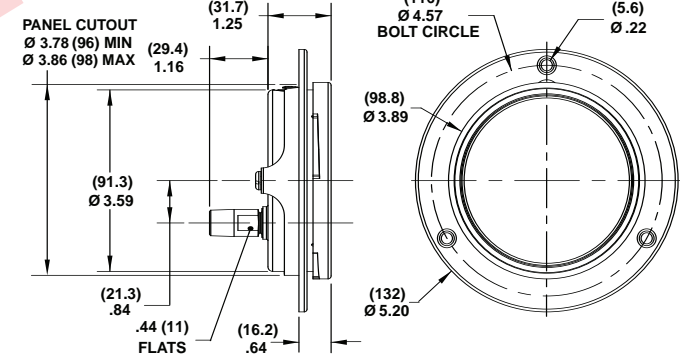

**2½" 1009 Lower and
Back Connect (XFW)**

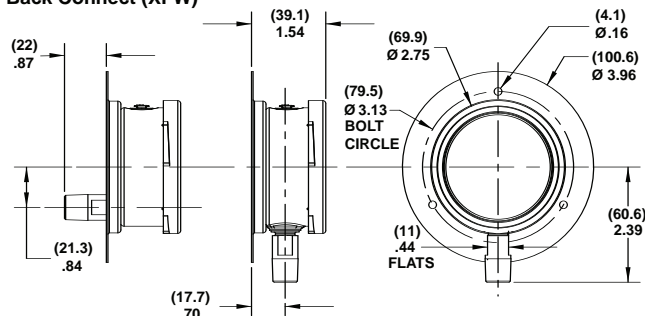

**3½" 1009 Lower and
Back Connect (XFW)**

